

HD Probe Lens System



- Interchangeable attachments: straight view, 45°, and 90°
- T3.3 to T22 aperture
- 5mm, 8mm, 12mm, 17mm, and 23mm prime lenses
- Waterproof to 9" to 14" (23 to 36cm) deep.
- Optically designed specifically for HD
- Barrel Diameter: 1.7" (43mm)
- Length: Straight View -19" (48cm)
 90 Degree View - 14" (35cm)
 45 Degree View - 16" (40cm)

innovision[®]
OPTICS

1719 21st Street Santa Monica
California 90404 USA
Telephone: 310-453-4866
www.innovision-optics.com

HD Probe System Specs

Speed:	T3.3-T22
Barrel Diameter:	1.7"(43mm)
Objective Lenses:	5mm, 8mm, 12mm, 17mm, 23mm
Focusing Ring:	72 teeth, 0.8 module
Optional Accessories:	Remote focus control, Close focus shims, Shipping cases

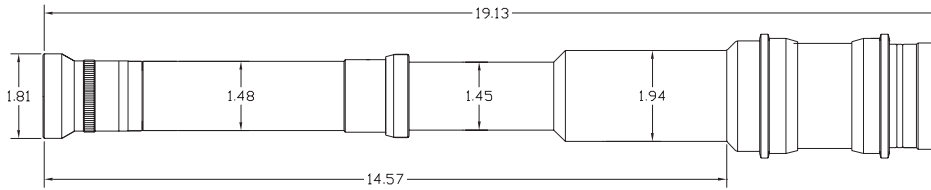

HD Probe in Direct View

Weight:	5lbs (2kg)
Length:	19" (48cm)
Waterproof to:	14" (36cm)Deep

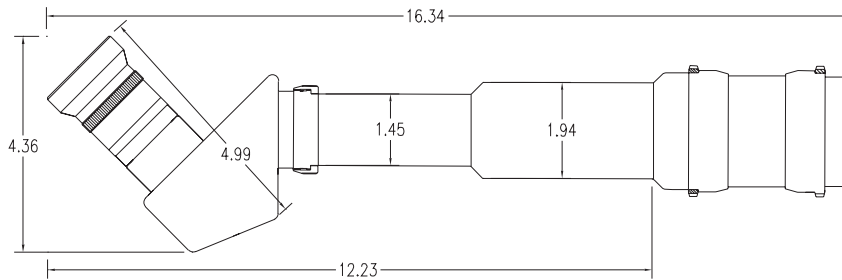

HD Probe in 45 Degree View

Weight:	4.9lbs (2kg)
Length:	16.3" (39cm)
Waterproof to:	12" (23cm)Deep

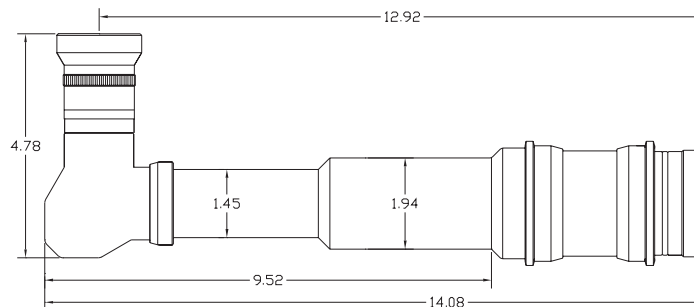

HD Probe in 90 Degree View

Weight:	4.9lbs (2kg)
Length:	14" (35cm)
Waterproof to:	9" (23cm)Deep

innovision
OPTICS

1719 21st Street Santa Monica
California 90404 USA
Telephone: 310-453-4866
www.innovision-optics.com